

Safety Valve (SFV-IA Series)



Application:

- IDMC safety valves are used in sanitary pipeline in dairy, food, beverages and pharmaceutical industry.
- It is used to prevent inadmissible overpressure building-up in tanks, containers and plant sections.

Features:

- A low-cost and reliable product for continuous operation plants.
- Valves designed with Tri Clamp (TC) ferrule end connection for ease of assembly and maintenance.
- Hygienic design suitable for Cleaning-In-Place(CIP).
- Safety valves can be factory set for set pressure as per customer requirement.

Technical specifications:

- Size : SMS 38 (Pipe OD 1.5" suitable for ASTM A270)
- Product wetted steel parts : SS 316 L or SS 304
- Other steel parts : SS 304
- Product contact gaskets/seals : EPDM (suitable to US FDA 21 CFR 177.2600)
- Other gasket/seals : NBR
- Set pressure : 1 to 5.5 Bar
- Temperature range : 2°C to 90°C

Operation/working:

- The valve opens against a spring force, if the operating pressure increases beyond the set pressure.
- Safety valve is designed to open and relieve excess pressure from vessels or equipment and then shut-off to prevent further release of fluid when the system returns to normal pressure.

Standard dimensions:

Valve sizes	Dimensions in mm		
	OD	A	B
SMS 38	38.1	119	244

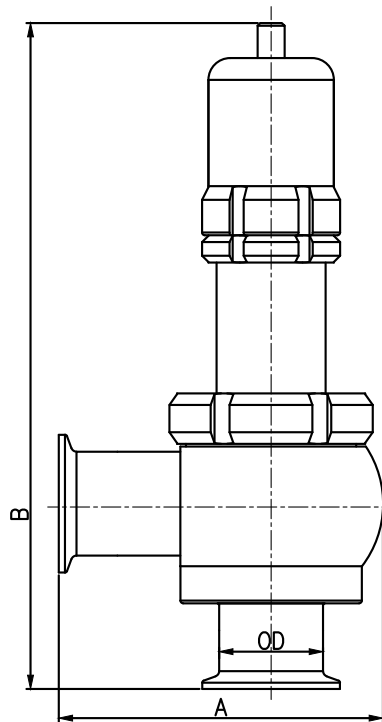

124-128, GIDC Estate, Vithal Udyognagar 388 121, Anand district, Gujarat, India, Ph: +91-2692-236375, 220100
idmc@idmc.com www.idmc.com Toll free:1800-103-3567
Gurugram: +91-124-4931370, Lucknow:+91-9451970174, Patna: +91-9934360635

Processing & packaging solutions to make food safe